



**Republic of the Philippines
University of the Philippines Cebu**

Gorordo Ave., Lahug, Cebu City

(032) 233-3497 loc 102

<https://www.upcebu.edu.ph/>

bac_sec.upcebu@up.edu.ph

BIDS AND AWARDS COMMITTEE

SUPPLEMENTAL/BID BULLETIN

ADDENDUM NO. 2020-12-022

This addendum is issued to modify or amend item/s in the **Repair and Replacement of Tiles of Various Buildings for UP Cebu.**

Attached is the following changes to the Bill of Quantities, Scope of Works, and Drawings of the said project.

For guidance and information of all concerned.

(sgd)

Lorel S. Dee, M.D.

BAC Chairperson

Received by the Bidder:

Date: _____

Project Name	Repair/Tiling of Greenovate Comfort Rooms (Male & Female)	25Nov2020
Location	Greenovate Dormitory	01
Attn		

BILL OF QUANTITIES/ BILL PRELIMINARIES

ITEM	DESCRIPTION	UOM	QTY	UNIT RATE		TOTAL AMOUNT
				MATERIALS	OTHERS/LABOR	
1.00	PRELIMINARIES					
	Mobilization/ Demobilization	sum	0.00	-	-	15,000.00
	Workers Permits	sum	0.00	-	-	
	SUB TOTAL - Preliminaries					10,000.00
2.00	Interior Fit Out (Tiling works)					
	Comfort Rooms					
	supply and installation of 60cm x 60cm non-skid homogenous floor tiles at CR	pcs	250.00	350.00	45,000.00	132,500.00
	40kg tile adhesive heavy duty	bags	25.00	350.00	-	8,750.00
	tile grout	kg	90.00	75.00	-	6,750.00
	replacement of floor drains; use stainless steel 6"x6" floor drains	pcs	23.00	500.00	-	11,500.00
	supply and installation of 30cm x 60cm homogenous tiles for CR perimeter walls only	pcs	480.00	280.00	50,000.00	184,400.00
	tile trims 6ft / length	lengths	100.00	200.00	-	20,000.00
	40kg tile adhesive heavy duty	bags	40.00	350.00	-	14,000.00
	tile grout	kg	100.00	75.00	-	7,500.00
	Supply and installation of synthetic granite or stone on the existing lavatory counters for both male and female	lot	1.00	45,000.00	12,000.00	57,000.00
	Main Rooms					
	supply and installation of 3mm vinyl tiles (wooden look) to entire GROUND FLOOR AREA	sqm	165.00	900.00	49,500.00	198,000.00
	demolition and scrapping of existing vinyl tiles	lot	1.00	-	23,500.00	23,500.00
	supply and installation of wood plank homogenous tiles 1200cm x 12cm for entry porch	pcs	45.00	720.00	2,500.00	34,900.00
	40kg tile adhesive heavy duty	bags	20.00	350.00	-	7,000.00
	tile grout	kg	85.00	75.00	-	6,375.00
	supply and installation of 3mm vinyl tiles (wooden look) to entire second floor general area, main stairs	sqm	142.00	900.00	42,600.00	170,400.00
	Stair nosing	lengths	5.00	250.00	2,000.00	3,250.00
3.00	Plumbing works					
	replacement of old exposed water supply blue pipes into 25mm PPR, PN20 on all tile embedded pipes; includes all fittings needed for an acceptable piping installation	lot	1.00	40,000.00	15,000.00	55,000.00
	pressure test after the installation; before installing the wall tiles	lot	1.00	-	2,000.00	2,000.00
	SUB TOTAL					942,825.00

SUMMARY

Preliminaries	10,000.00
Fit Out (DIRECT COST)	942,825.00
Contingencies (5% of Direct Cost)	47,141.25

TOTAL	999,966.25
--------------	-------------------

Prepared By 
 Ar. Ryan Anthony G. Genbiagon
 Sr. Architectural Associate - OCA



SCOPE OF WORKS

ITEM	DESCRIPTION	ITEM INCLUDED AND SCOPE OF WORKS
1.00 PRELIMINARIES		
	Mobilization/ Demobilization	Includes all costs for demobilization, dismantling of all temporary facilities and removal of all construction equipment, tools, personnel and debris out of the project site and/or University premises. Includes general cleaning of building and site; spic and span, ready for turnover and for use.includes
	Workers Permits	n/a
2.00 Interior Fit Out (Tiling works)		
	Comfort Rooms	
	supply and installation of 60cm x 60cm non-skid homogenous floor tiles at CR	For all comfort room tiles flooring and walls as specified; includes supply and installations of 60cm x 60cm non-skid homogenous tiles, 30cm x 60cm non-skid homogenous tiles bonding compound and accessories necessary to install the wall tiles, as specified and desired look and effect; including the installation of architectural profiles and tile trims; pure tile adhesive must be use heavy duty especially on the walls; Includes bonding compound and other chemical and accessories to complete the installation as required for the acceptable method of installation of the synthetic granite or stone
	40kg tile adhesive heavy duty	
	tile grout	
	replacement of floor drains; use stainless steel 6"x6" floor drains	
	supply and installation of 30cm x 60cm homogenous tiles for CR perimeter walls only	
	tile trims 6ft / length	
	40kg tile adhesive heavy duty	
	tile grout	
	Supply and installation of synthetic granite or stone on the existing lavatory counters for both male and female	
	Main Rooms	
	supply and installation of 3mm vinyl tiles (wooden look) to entire GROUND FLOOR AREA	For all main room tiles flooring as specified; includes supply and installations of 1200cm x 12cm non-skid homogenous tiles at entry porch, bonding compound and accessories necessary to install the wall tiles, as specified and desired look and effect; including the installation of architectural profiles and tile trims; pure tile adhesive must be use heavy duty especially on the walls; For all interior flooring as specified; includes vinyl tiles, bonding compound and accessories necessary to install the vinyl tiles or flooring.
	demolition and scrapping of existing vinyl tiles	
	supply and installation of wood plank homogenous tiles 1200cm x 12cm for entry porch	
	40kg tile adhesive heavy duty	
	tile grout	
	supply and installation of 3mm vinyl tiles (wooden look) to entire second floor general area, main stairs	
	Stair nosing	
3.00 Plumbing works		
	replacement of old exposed water supply blue pipes into 25mm PPR, PN20 on all tile embedded pipes; includes all fittings needed for an acceptable piping installation	Includes pipes and fittings for potable water supply, including valves, water meters, faucets, air chambers, etc.
	pressure test after the installation; before installing the wall tiles	OCA must witness and sign the testing form

Prepared By

 Ar. Ryan Anthony G. Genoblagon
 Sr. Architectural Associate - OCA

LEGEND:

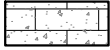
-  60cmX60cm NON-SKID HOMOGENOUS TILES FOR GROUND FLOOR GENERAL AREAS ;DESIGN TO BE APPROVED BY UP CEBU / OCA
-  60cmX60cm NON-SKID HOMOGENOUS TILES FOR CR's; DESIGN TO BE APPROVED BY UP CEBU / OCA
-  3mm THICK VINYL TILES FOR SECOND FLOOR GENERAL AREA & ENTRY PORCH; DESIGN TO BE APPROVED BY UP CEBU / OCA
-  WOOD PLANK HOMOGENOUS TILES FOR ENTRY PORCH; DESIGN TO BE APPROVED BY UP CEBU / OCA



MALE CR

INSTALL/CLAD EXISTING LAVATORY COUNTER WITH SYNTHETIC STONE/GRANITE INCLUDING 200mm SPLASH BOARD WITH THE SAME MATERIAL (SYNTHETIC STONE/GRANITE); DARK COLOR TO BE APPROVED BY UP CEBU OR OCA



FEMALE CR

INSTALL/CLAD EXISTING LAVATORY COUNTER WITH SYNTHETIC STONE/GRANITE INCLUDING 200mm SPLASH BOARD WITH THE SAME MATERIAL (SYNTHETIC STONE/GRANITE); DARK COLOR TO BE APPROVED BY UP CEBU OR OCA

ARCHITECTURAL GENERAL NOTES:

1. ALL DIMENSION SHALL HAVE PREFERENCE OVER SCALE.
2. ALL DIMENSIONS SHALL BE VERIFIED IN THE FIELD BEFORE PROCEEDING WITH THE WORK.
3. THE OWNER AND THE ARCHITECT SHALL BE NOTIFIED OF ANY CORRECTIONS.
4. WHERE DISCREPANCIES EXIST BETWEEN DRAWING OF VARIOUS TRADES, ARCHITECTURAL SHALL GENERALLY BE ASSUMED TO GOVERN. CONSULT THE ARCHITECT BEFORE PROCEEDING WITH THE WORK.
5. DETAILS NOT SHOWN ARE SIMILAR IN CHARACTER TO THOSE DETAILS WITH SPECIFIC DIMENSIONS, WHEREIN DESIGN INTENT CAN BE DETERMINED. CONSULT THE ARCHITECT BEFORE PROCEEDING WITH THE WORK.
6. ALL WORK SHALL CONFORM TO ALL APPLICABLE AND GOVERNING AUTHORITIES AND SHALL BE OF BEST PRACTICE OF EACH TRADE.

OFFICE OF THE BUILDING OFFICIAL
 REPUBLIC OF THE PHILIPPINES
 DEPARTMENT OF PUBLIC WORKS & HIGHWAYS
 CEBU CITY

RECOMMENDING APPROVAL:

HEAD, ARCHITECTURAL SECTION DATE

BUILDING OFFICIAL DATE

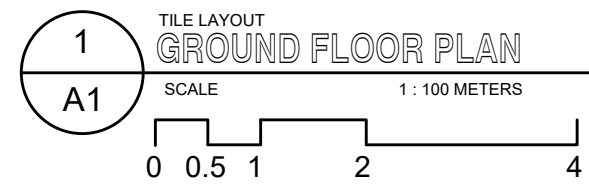
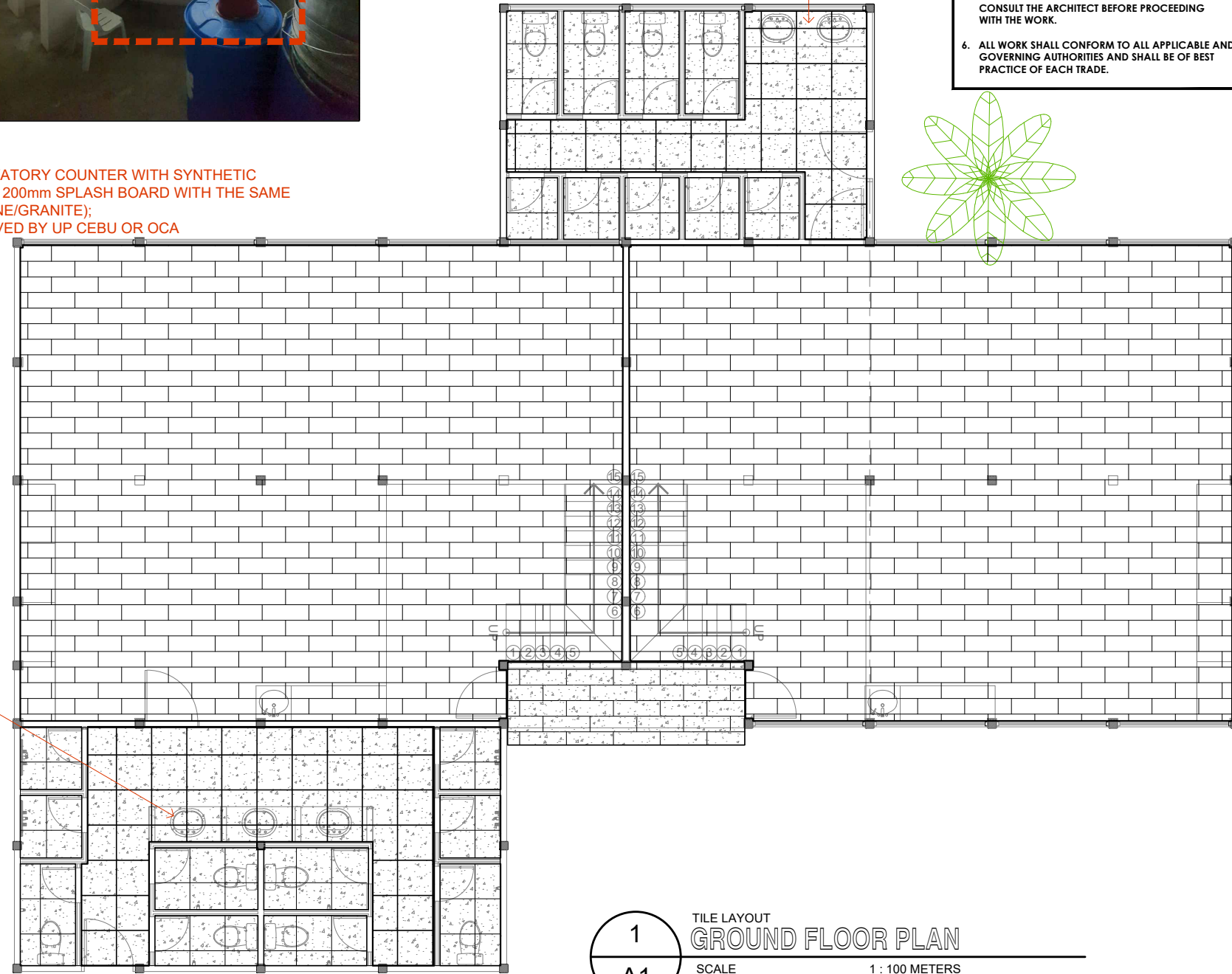

 <p>UNIVERSITY OF THE PHILIPPINES CEBU</p> <p>OCA OFFICE OF THE CAMPUS ARCHITECT</p>	<p>RA 9266</p> <p><small>Drawings and specifications duly signed, stamped or sealed, as instruments of service, are the intellectual properties and documents of the architect, whether the object for which they are made is executed or not, it shall be unlawful for any person, without the consent of the architect or author of said documents, to duplicate or to make copies of said documents for use in the repetition of and for other projects or buildings, whether executed partly or in whole. (Art. III, Sec. 20, Item 4).</small></p>	<p>ARCHITECT OF RECORD:</p> <p>RYAN ANTHONY G. GENOBIAGON ARCHITECT</p> <table border="1" style="width: 100%; border-collapse: collapse;"> <tr> <td>PRC No. 27419</td> <td>VALIDITY: 02.08.2023</td> </tr> <tr> <td>PTR No. 186-88-49</td> <td>DATE: 01.03.2020</td> </tr> <tr> <td>PLACE: CEBU CITY</td> <td>TIN: 401-198-119-000</td> </tr> </table>	PRC No. 27419	VALIDITY: 02.08.2023	PTR No. 186-88-49	DATE: 01.03.2020	PLACE: CEBU CITY	TIN: 401-198-119-000	<p>PROJECT TITLE:</p> <p>UNIVERSITY OF THE PHILIPPINES CEBU REPAIR/TILING OF GREENOVATE COMFORT ROOMS (MALE & FEMALE) LAHUG CEBU, CITY</p>	<p>OWNER'S APPROVAL:</p> <p>ATTY. LIZA D. CORRO UP CEBU DEAN</p>	<p>SHEET CONTENTS:</p> <p>AS SHOWN</p>	<p>DESIGN BY:</p> <p>CAD BY:</p> <p>CHECKED BY:</p>	<p>SHEET NO.</p> <p style="font-size: 2em; font-weight: bold;">A</p> <p style="font-size: 2em; font-weight: bold;">01</p> <p>OF</p> <p style="font-size: 2em; font-weight: bold;">02</p> <p>SHEETS</p>
	PRC No. 27419	VALIDITY: 02.08.2023											
PTR No. 186-88-49	DATE: 01.03.2020												
PLACE: CEBU CITY	TIN: 401-198-119-000												